

## Ultimate Duty Spring Retractable Reels

**Air/Water/Oil/Grease** - 3/8", 1/2", 3/4", 1", 1 1/4", 1 1/2" I.D.

Series 9000 mobile base reels offer the greatest amount of stability for high volume air, water, diesel fuel and gasoline. Ideal for portable service trucks, permanent service or plant work areas. A durable baked-on powder coat finish produces a rugged corrosion resistant product suitable for a wide variety of heavy duty applications. Basic reels without hose will handle air, water or oil; consult Reelcraft for other applications.

Made  
  
in USA

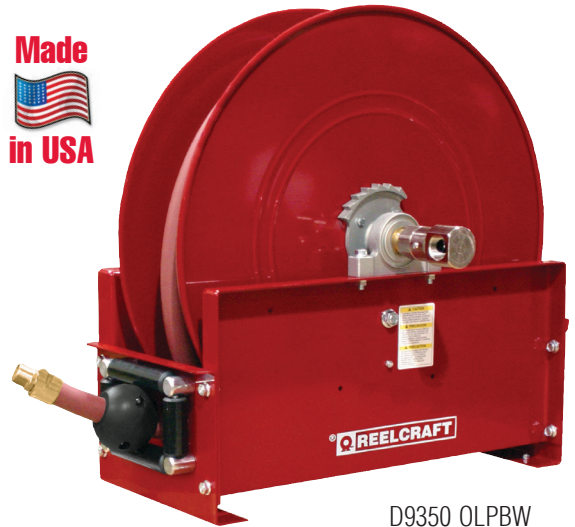

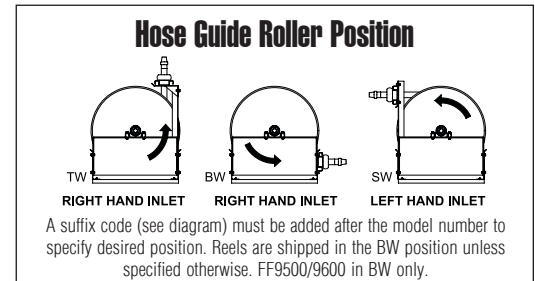
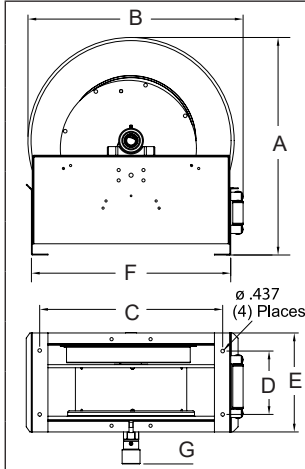

D9350 OLPBW

	Dimensions - Size Index							
	1		2		3		4	
	in	mm	in	mm	in	mm	in	mm
<b>A</b>	26 3/8	670	26 3/8	670	26 3/8	670	26 1/4	667
<b>B</b>	26 1/4	667	26 1/4	667	26 1/4	667	25	635
<b>C</b>	22 1/4	565	22 1/4	565	22 1/4	565	22	559
<b>D</b>	7 3/4	197	13 1/2	343	7 3/4	197	9 1/2	241
<b>E</b>	12	305	17 3/4	451	13 3/8	340	17 1/4	438
<b>F</b>	24 1/8	613	24 1/8	613	24 1/8	613	24 1/4	616
<b>G</b>	4 3/4	121	3 7/8	98	4 1/2	114	3 7/8	98



\*Series G9000 reels have an external drive spring and a removable gooseneck.

Model with Hose	Shipping Weight		Hose I.D.		Hose O.D.		Hose Length		**Max Pressure	NPT(M) Hose Outlet	NPT(F) Reel Inlet	Model without hose & bumper	Shipping Weight		Pressure	Size Index #		
	lbs	kg	in	mm	in	mm	ft	m	psi	bar	in		in	lbs			kg	psi
<b>Low Pressure Air/Water Reels</b>													Maximum temperature 150 °F (65 °C) w/hose / 210 °F (99 °C) w/o hose    **Maximum working pressure at 70 °F (20 °C)					
D9275 OLP	122	55	1/2	13	.750	19	75	23	300	21	1/2	1/2	D9200 OLP	115	52	500	35	1
D9299 OLP	127	58	1/2	13	.750	19	100	30	300	21	1/2	1/2	D9205 OLP	115	52	500	35	1
D9350 OLP	140	64	3/4	19	1.075	27	50	15	250	17	3/4	3/4	D9300 OLP	115	52	500	35	1
D9375 OLP	152	69	3/4	19	1.075	27	75	23	250	17	3/4	3/4	D9300 OLP	115	52	500	35	1
D9399 OLPBW	143	65	3/4	19	1.075	27	100	30	250	17	3/4	3/4	D9305 OLPBW	115	52	500	35	3
D9450 OLP	157	71	1	25	1.375	35	50	15	250	17	3/4	1	D9400 OLP	115	52	500	35	1
D9465 OLPBW	164	74	1	25	1.375	35	65	20	250	17	3/4	1	D9405 OLPBW	115	52	500	35	3
Not available with hose			1 1/4	32	1.750	44	50	15	---	---	-----	1 1/2	FF9500 OLPBW 	125	57	600	41	2
Not available with hose			1 1/2	38	2.000	51	50	15	---	---	-----	1 1/2	FF9600 OLPBW 	135	61	600	41	2
<b>Medium Pressure Oil Reels</b>													Maximum temperature 210 °F (99 °C)					
D9275 OMP	131	59	1/2	13	.820	21	75	23	3000	207	1/2	1/2	D9200 OMP	117	53	3000	207	1
D9350 OMP	142	64	3/4	19	1.188	30	50	15	1250	86	3/4	3/4	D9300 OMP	117	53	3000	207	1
Not available with hose			3/4	19	1.188	30	75	23	---	---	-----	3/4	G9300 OMPBW*	160	73	3000	207	4
E9450 OMP	160	73	1	25	1.480	38	50	15	3000	207	1	1	E9400 OMP	120	54	3000	207	1
Not available with hose			1	25	1.480	38	75	23	---	---	-----	1	G9400 OMPBW*	159	72	3000	207	4
<b>High Pressure Grease Reels</b>													Maximum temperature 210 °F (99 °C)					
D9175 OHP	153	69	3/8	10	.730	19	75	23	4800	331	3/8	1/2	D9100 OHP	118	54	5000	345	1

Models listed with an icon can ship same day upon request when the order is received by 1:00 PM Eastern Time for quantities of 10 or fewer.

 Indiana Warehouse     California Warehouse  
 Indiana & California Warehouses     Canadian Warehouse



### Interactive Reel Catalog

Visit [www.reelcraft.com/catalog](http://www.reelcraft.com/catalog) for complete product specifications, available parts and accessories.

**Prop 65:**  **WARNING:**  
Cancer and Reproductive Harm  
[www.P65Warnings.ca.gov](http://www.P65Warnings.ca.gov).

Customer Service: 1.855.634.9109  
All Other Calls: 1.800.444.3134

