

New Product Announcement | Series SW

Heavy Duty, Spring Retractable Single Line Welding Hose Reels Series SW

The new Reelcraft Series SW single line hose reels expands the industry leading welding series and is specifically designed to improve work area safety and increase efficiency and productivity when transferring fuel gases.

Reel

- Hard coated wear-resistant aluminum double-sealed full flow swivel
- Corrosion resistant baked-on powder coat

Hose

- Ideal for welding service – meets ARPM IP-7 and CGA E-1 standards for T-grade
- Non-conductive
- **Tube:** Synthetic rubber compound compatible with all common welding fuel gases
- **Reinforcement:** Spiral synthetic yarn
- **Cover:** Red synthetic rubber ribbed surface

Fuel gases commonly used in the welding, pre-heating, soldering, brazing, laboratory, heat gun, and cutting industries including, but not limited to, Acetylene, Hydrogen, Methane, Natural Gas, LP Gas, Mapp, and Propane



SW5450 OLPT

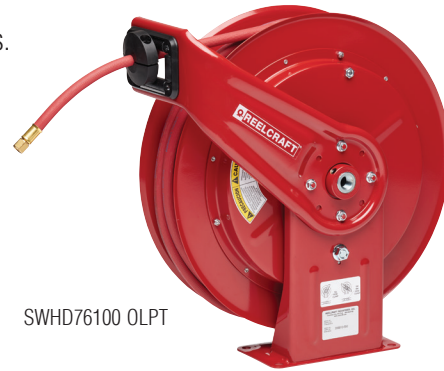

SWHD76100 OLPT

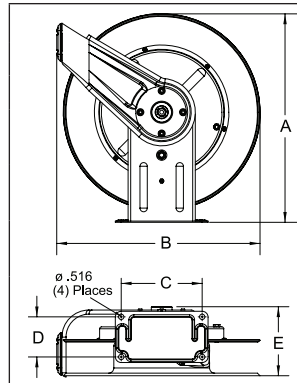

	Dimensions - Size Index					
	1		2		3	
	in	mm	in	mm	in	mm
A	12 ⁷ / ₈	327	20 ¹ / ₄	514	20 ¹ / ₄	514
B	12 ⁵ / ₈	321	19 ³ / ₄	502	19 ³ / ₄	502
C	8	203	7 ⁷ / ₈	200	7 ⁷ / ₈	200
D	2 ¹ / ₂	64	3 ⁷ / ₈	98	3 ⁷ / ₈	98
E	5 ⁵ / ₈	143	7	178	8 ¹ / ₄	210

SW5000 reels have four 5/16" (8 mm) diameter mounting holes.

Model with hose	Shipping Weight		Hose I.D.		Hose O.D.		Hose Length		Max Pressure		Hose Outlet B Size LH Thread	NPT(F) Reel Inlet	Size Index #
	lbs	kg	in	mm	in	mm	ft	m	psi	bar	in	in	
SW5425 OLPT	26	12	1/4	6	0.530	13	25	8	200	14	9/16 - 18(F)	1/4	1
SW5450 OLPT	28	13	1/4	6	0.530	13	50	15	200	14	9/16 - 18(F)	1/4	1
SW7650 OLPT	43	20	3/8	10	0.660	17	50	15	200	14	9/16 - 18(F)	1/2	2
SWHD76100 OLPT	75	34	3/8	10	0.660	17	100	30	200	14	9/16 - 18(F)	1/2	3

Maximum temperature 150 °F (65 °C). Reel outlet 9/16-18 (M) B-Size fitting.

Single Line Welding - Inlet Hose Assemblies

Part Number	Hose I.D.		Hose Length		Max Pressure		End Fitting	Weight	
	in	mm	ft	m	psi	bar	in	lbs	kg
S601162-2	1/4	6	2	.61	200	14	9/16 - 18 LH(F)	0.5	0.2
S601162-4	1/4	6	4	1.22	200	14	9/16 - 18 LH(F)	1	0.5
S601162-6	1/4	6	6	1.83	200	14	9/16 - 18 LH(F)	1.5	0.7
S601163-2	3/8	10	2	.61	200	14	9/16 - 18 LH(F)	0.5	0.2
S601163-4	3/8	10	4	1.22	200	14	9/16 - 18 LH(F)	1	0.5
S601163-6	3/8	10	6	1.83	200	14	9/16 - 18 LH(F)	1.5	0.7

Inlet hose assemblies include all adapters needed to plumb into reel.

Customer Service: 1.855.634.9109
All Other Calls: 1.800.444.3134

www.reelcraft.com
reelcraft@reelcraft.com

Single Line Welding - Hose Assemblies

Part Number	Hose I.D.		Hose Length		Max Pressure		End Fitting	Weight	
	in	mm	ft	m	psi	bar	in	lbs	kg
S601162-25	1/4	6	25	8	200	14	9/16 - 18 LH(F)	6	3
S601162-50	1/4	6	50	15	200	14	9/16 - 18 LH(F)	13	6
S601163-50	3/8	10	50	15	200	14	9/16 - 18 LH(F)	13	6
S601163-100	3/8	10	50	15	200	14	9/16 - 18 LH(F)	27	12

